



## 27 Woodland Road, Kenilworth, CV8 2FJ

£389,000

- Three Bedroom 1950s Semi Detached House
- Energy Rating D - 64
- Garage Conversion Into Office/Reception Room/Occasional Bed 4
- Warwick District Council Tax Band D
- Open Porch & Reception Hall
- Fitted Kitchen
- Three Piece Modern Bathroom With Shower



- Through Living & Dining Room
- Three Bedrooms- Two Doubles
- Large Rear Garden

Ground Floor

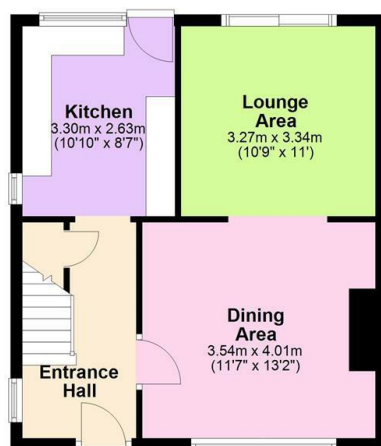
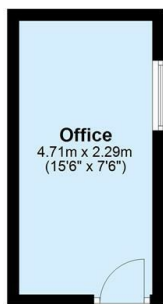

First Floor

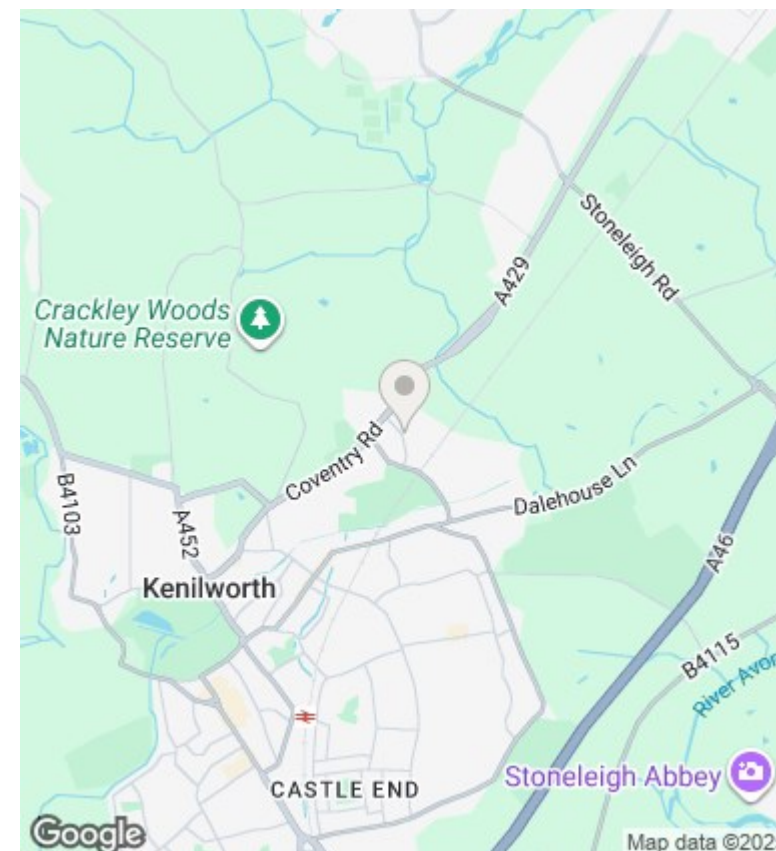
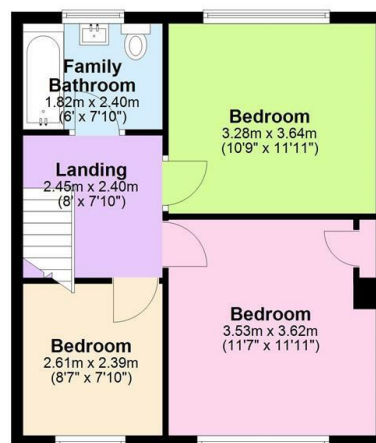

## Directions

## Viewings

Viewings by arrangement only. Call 01926 857244 to make an appointment.

## Council Tax Band

D

## EPC Rating:

D

Energy Efficiency Rating		
	Current	Potential
Very energy efficient - lower running costs		
(92 plus) <b>A</b>		
(81-91) <b>B</b>		
(69-80) <b>C</b>		78
(55-68) <b>D</b>	64	
(39-54) <b>E</b>		
(21-38) <b>F</b>		
(1-20) <b>G</b>		
Not energy efficient - higher running costs		
<b>England &amp; Wales</b>	EU Directive 2002/91/EC	