



The Hayes, Apartment 8 Leek Wootton, Warwick, CV35 7QU

£1,750 Per Calendar Month

- Quality Two Bedroom Apartment
- EPC Rating - D
- Mansion House Conversion
- Available NOW
- Recently Renovated And Refurbished
- Lift To All Floors
- Beautiful Setting
- Fully Fitted Kitchen
- Ample Parking
- Council Tax Band - E

First Floor Apartment

Approx. 88.1 sq. metres

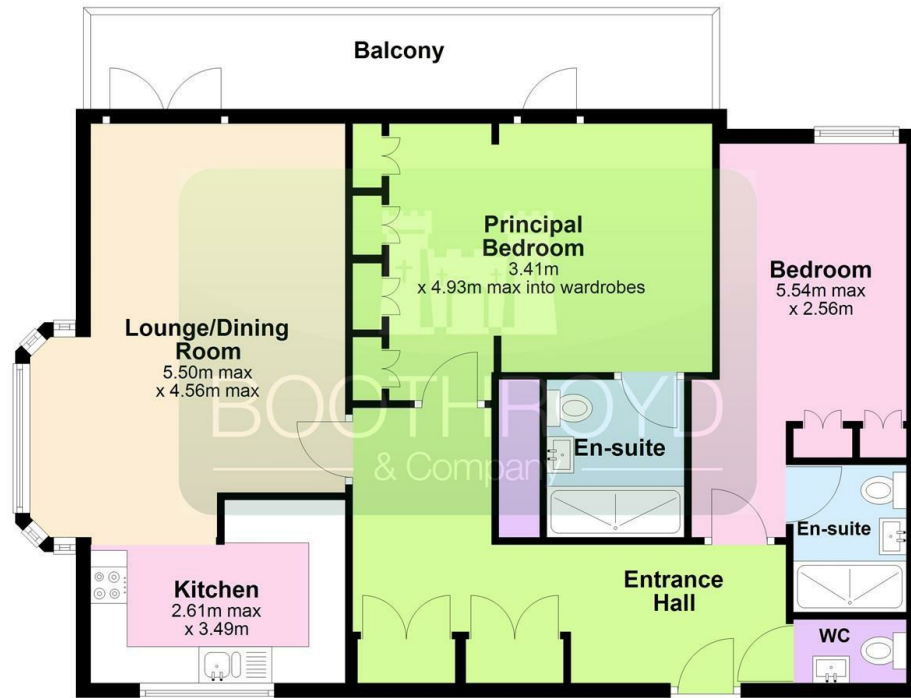

Total area: approx. 88.1 sq. metres

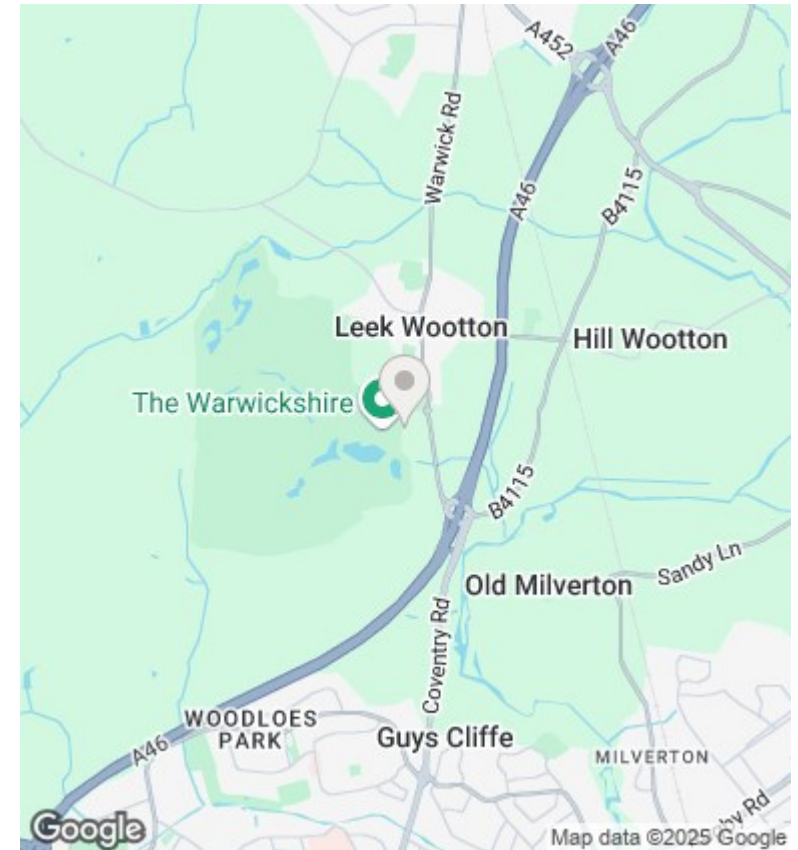

Directions

Viewings

Viewings by arrangement only. Call 01926 857244 to make an appointment.

Council Tax Band

E

EPC Rating:

D

Energy Efficiency Rating		
	Current	Potential
Very energy efficient - lower running costs		
(92 plus) A		
(81-91) B		84
(69-80) C		
(55-68) D	62	
(39-54) E		
(21-38) F		
(1-20) G		
Not energy efficient - higher running costs		
England & Wales	EU Directive 2002/91/EC	